

Xiaolei

Super Smart Switch

(Smart Knob Switch)



Manual

www.xiaolei.com.cn

System Diagram

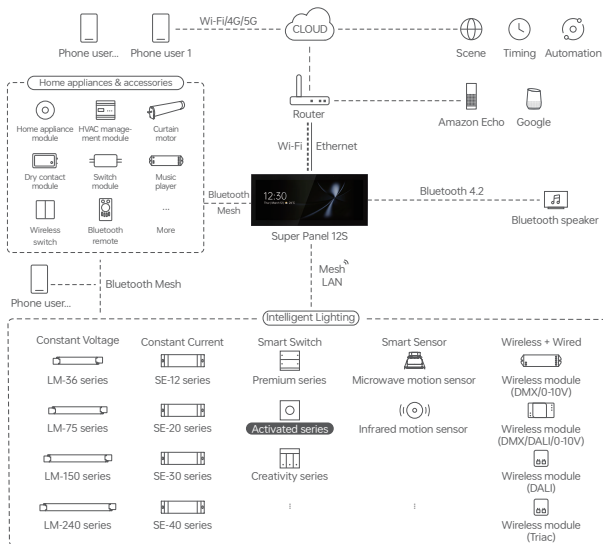

Product Features

- Control on/off, brightness, light colors by pressing or rotating the knob.
- Endless rotation knob allows smooth and delicate adjustment. Adjust lighting or device effects as you wish.
- Bluetooth 5.0 SIG Mesh with strong networking capability makes local control reliable and stable.
- Work with a smart gateway to achieve a variety of automation.
- No wiring required. Stick this battery-powered switch anywhere you like.

Technical Specs

Model	SQ-B
Wireless Type	Bluetooth 5.0 SIG Mesh
Power Supply	Battery Powered
Input Voltage	3Vdc (Button Battery CR2032×2)
Working Temperature	-20°C~55°C
Working Humidity	≤80%RH
Net Weight	75g
Dimensions	86×86×25mm (L×W×H)
Colors Available	Grey, Gold, White



Product Images



Knob



Insulation sheet

(Detach the plate from the switch to pull it out)

Product Size

Unit: mm

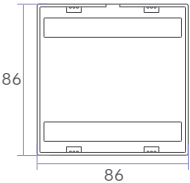

Knob Instructions



Single press



Double press



Rotate



Long press

Note: Knob actions will vary depending on the device you bind to it.

Action Device	Single press	Double press	Rotate	Long press
DIM light	ON/OFF	No device action	Adjust BRT	BRT ±
CT light	ON/OFF	Switch mode (BRT/CT)	Adjust current mode (BRT/CT)	BRT ±
RGB light	ON/OFF	Switch mode (BRT/RGB)	Adjust current mode (BRT/RGB color)	BRT ±
RGBW light	ON/OFF	Switch mode (RGBW/RGB/W)	Adjust current mode (RGBW/RGB color/W)	Current mode's BRT ±
RGBCW light	ON/OFF	Switch mode (RGBCW/RGB/CW)	Adjust current mode (RGBCW/RGB color/CW color)	Current mode's BRT ±



Single press



Double press



Rotate



Press and rotate

Note: Knob actions will vary depending on the device you bind to it.

Action Device	Single press	Double press	Rotate	Press and rotate
Music player	Play music	Pause music	Left rotation (Volume-) Right rotation (Volume+)	Left rotation (Previous song) Right rotation (Next song)
Bluetooth curtains	Open/Close	Pause	Adjust curtain fullness (Left rotation:Open) (Right rotation:Close)	No device action
Vertical blinds	Open/Close	Pause	Blinds direction (Left rotation:Moving blinds to the left) (Right rotation:Moving blinds to the right)	No device action

Recommended Applications

1. Work with a Bluetooth LED driver to wirelessly control the lamp.

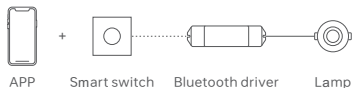

2. Work with a Bluetooth music player to play music freely.

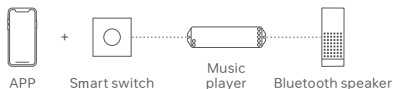

3. Work with a Bluetooth curtain motor to intelligently control the curtain.

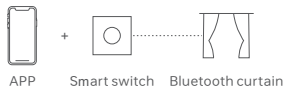

4. Work with a smart gateway to realize visual control and automation.



5. Intelligent control. Set up more app configs as you like.

App Operating Instructions

1. Register an account

Scan the QR code below with you mobile phone and follow the prompts to complete the app installation. Then open the App and log in or register an account.



2. Connect to the network

Create a home if you are a new App user. Click 【+】 icon in the upper right corner of “Room” interface to access “Add device” page. Pick 【Smart switch】 from the list and follow the on-screen prompts to add the device.

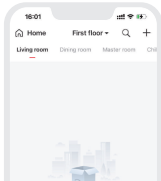

3. Bind a device

In “Room” interface, click the smart switch you have added to access its control interface. Long press the knob on the screen and select **【Bind object-Device】** , then save your setting. Next, follow the on-screen prompts to activate the smart switch.

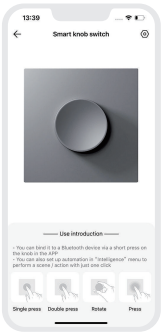

4. Automation

Please be sure a smart gateway is added to your home, such as Super Panel 12S. Tap **【Automation】** in “Intelligence” interface and click **【 + 】** icon to create automation. You can choose local or cloud execution option, then set the trigger conditions and executing action. When the conditions you set are met, a series of device actions will be automatically triggered to perform and remote linkage is achieved as well.

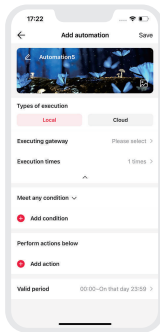
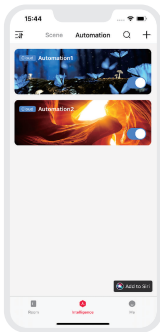

FAQs

1. How to reset a switch to factory defaults?

Long press the knob for 15s and release it until the indicator light flashes fast. Within 3s, short press the knob 3 times and the indicator light flashes slowly, which means the switch has been reset to factory defaults.

2. What should I do if I fail to search the device via APP?

Please check below:

- Please make sure the device is powered on normally and is in the activated state.
- Please keep you mobile phone and device as close as possible. The recommended distance between them is no more than 15 meters.
- Please make sure the device hasn't been added yet. If it has, please reset the device to factory defaults manually.

3. Why does the indicator light blink 5 times only during operations?

This is a low-battery warning and the battery should be replaced in time.

Attentions

- Product installation and commissioning should be done by a qualified professional.
- Good heat dissipation will extend the life the product. Please install the product in a environment with good ventilation.
- Avoid being close to large metal objects or stacking them to avoid signal interference affecting use.
- When you install this product, please avoid being near a large area of metal objects or stacking them to prevent signal interference.

Warranty Agreement

Warranty periods from the date of delivery: 2 years.

Free repair or replacement services for quality problems are provided within warranty periods.

Warranty exclusions below:

Following conditions are not within the guarantee range of free repairing or replacement services:

- Beyond warranty periods.
- Any artificial damage caused by high voltage, overload, or improper operations.
- Products with severe physical damage.
- Damage caused by natural disasters and force majeure.
- Warranty labels and barcodes have been damaged.
- No any contract signed by LTECH.

1. Repair or replacement provided is the only remedy for customers. LTECH is not liable for any incidental or consequential damage unless it is within the law.
2. LTECH has the right to amend or adjust the terms of this warranty, and release in written form shall prevail.

* This manual is subject to changes without further notice. Product functions depend on the goods. Please feel free to contact our official distributors if you have any question.