

MINI LED Remote (Programmable)



The MINI series LED remote uses RF 2.4GHz wireless transmission technology and the control distance (under no interference) can be up to 30 meters.

Connect to a P5 controller with 5 channel outputs which supports DIM/CT/RGB/RGBW/RGBCW light. One remote can control a large amount of controllers within the effective range to achieve different functions, such as turning lights on/off, adjusting brightness, CT, static RGB color and effects of dynamic modes. Using the remote, you're able to program and modify 9 built-in dynamic modes, turn on/off the power off memory mode, and set the fade time between 1s and 9s for controllers. These features meet user needs for different lighting applications.

Technical parameters

Model	M9
Color	White
Wireless protocol	RF 2.4GHz
Working voltage	3Vdc (Button battery CR2032×1)
Standby current	<1uA
Distance of remote	30M (Under no interference)
Working temp.	-30°C~55°C
Weight	40g±10g
Dimensions	104×58×9mm [Remote], 108×63×14mm [Remote + Holder]

Dimensions

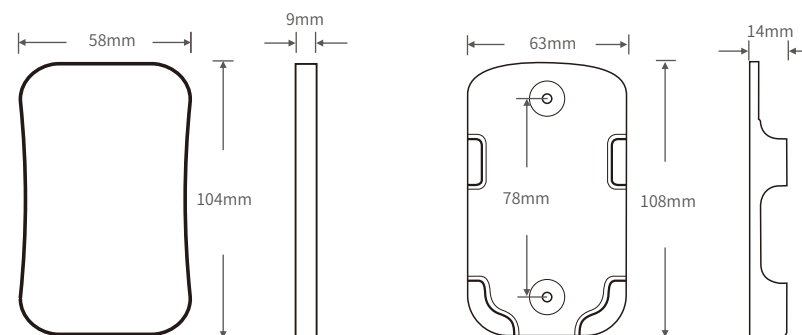

Remote

Remote holder

Product installation

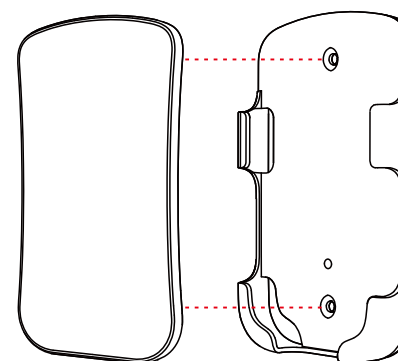

Two ways to fix the remote holder:

1. Fix the remote holder in the wall with two screws.
2. Fix the remote holder in the wall with a 3M adhesive.

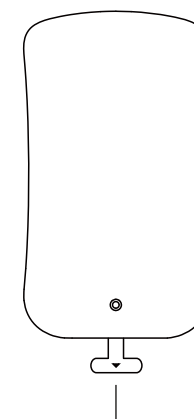

Note: Please pull out the battery tab before first use

DimensionsProduct installation

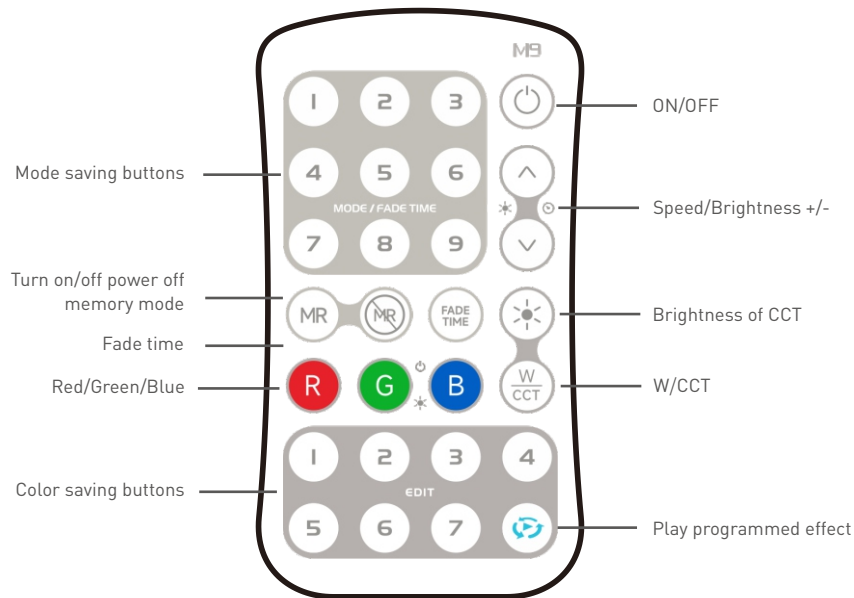

ON/OFF: Short press to turn on/off the light.

Red/Green/Blue: Short press to turn on or off the static red/green/blue channel; Long press to adjust the brightness of the current channel.

W/CCT: Short press to turn on/off the W/CCT channel; Long press to adjust the brightness of the W channel or adjust the color temperature of the CCT channel.

Brightness of CCT: Long press to adjust the brightness of the CCT channel.

Color saving buttons: Short press to turn on the saved static color; Long press to save the current static color.

Play programmed effect : Short press to switch between jumping, gradient, and strobing. 3 dynamic effects (used in transitioning to the next saved static color); Long press to loop playing the 12 dynamic modes.

Mode saving buttons: Short press to turn on dynamic mode; Long press to save the current dynamic effect as a dynamic mode.

Speed/Brightness +/-: Short press to adjust the speed of dynamic modes; Long press to adjust the brightness of dynamic modes.

Turn on/off power off memory mode: Short press to turn on/off the memory mode of the current controller.

Fade time: Short press the "FADE TIME" button and the "Mode saving button" 1-9 to set up the fade time between 1s and 9s for controllers.

Reset button functions

Reset static colors:

Short press Red, Green and Blue button to turn off all the static color channels. Long press the color saving button you want to reset, then the current static color will be removed.

Reset dynamic modes:

Long press the color saving button "5" and the "Play programmed effect" button at the same time until the indicator light flashes several times and then goes out, which means all the dynamic modes are reset successfully.

Sync the dynamic modes of the remote to the controller:

Long press the color saving button "1" and "4" until the indicator light flashes several times and then goes out, which means the edited dynamic modes of the remote are synced to the controller.

Note: If you have reset the dynamic modes of the remote, please sync the dynamic modes of the remote to the controller again so as to avoid the inconsistent dynamic modes between the remote and the controller that might lead to abnormal effects.

Pair the controller with the remote

Two methods available for users to pair/unpair the controller.

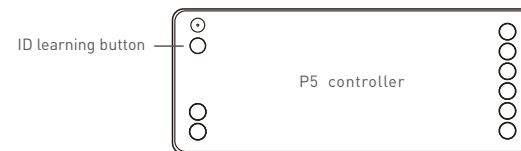

Method 1: Pair/unpair the controller using the button

Pair the controller:

1. Short press the ID learning button on the controller and the load light flashes;
2. Press any zone button on the remote within 15 s until the load light flashes and then stays on, which means pairing is successfully done.

Unpair the controller:

Press the ID learning button on the controller for 10s. The load light flashes 5 times which means all paired controllers have been removed from the remote.

Method 2: Pair/unpair the controller by powering it on

Pair the controller:

1. Power off the controller;
2. After powering on the controller again, press any zone button on the remote within 3 s until the load light flashes and then stays on, which means pairing is successfully done.

Unpair the controller:

Power on and off the controller for 10 consecutive times. The load light flashes 5 times which means all paired controllers have been removed from the remote.

Indicator light status

- When the light turns on and you press any button, the remote indicator light will be red.
- If there is no any press on a button, the remote will enter the sleep state in 30s. You need to press any button to exit the sleep state.

Note: When you press the button and the LED light doesn't light up, it is because the battery is out of power. Please replace the battery in time.

Transportation and Storage

1. Transportation

Products can be shipped via vehicles, boats and planes.

During transportation, products should be protected from rain and sun. Please avoid severe shock and vibration during the loading and unloading process.

2. Storage

The storage conditions should comply with the Class I Environmental Standards. The products that have been stored for more than six months are recommended to be re-inspected and can be used only after they have been qualified.

Attentions

- Please use in a dry indoor environment;
- When installing the battery, please connect the positive and negative terminal correctly. If the remote will not be used for a long period, take the battery out;
- When the remote distance is shorten and or the remote doesn't work frequently, please change the battery in time;
- Please carefully take it and put it down to prevent falls that cause damage;
- If a fault occurs, please do not attempt to fix products by yourself. If you have any question, please contact your suppliers.

* This manual is subject to changes without further notice. Product functions depend on the goods. Please feel free to contact our official distributors if you have any question.

Warranty Agreement

- Warranty periods from the date of delivery: 5 years.
- Free repair or replacement services for quality problems are provided within warranty periods.

Warranty exclusions below:

Following conditions are not within the guarantee range of free repairing or replacement services:

- Beyond warranty periods;
- Any artificial damage caused by high voltage, overload, or improper operations;
- Products with severe physical damage;
- Damage caused by natural disasters and force majeure;
- Warranty labels and barcodes have been damaged.
- No any contract signed by LTECH.

1. Repair or replacement provided is the only remedy for customers. LTECH is not liable for any incidental or consequential damage unless it is within the law.

2. LTECH has the right to amend or adjust the terms of this warranty, and release in written form shall prevail.

MINI LED遥控器 (编程)



产品尺寸

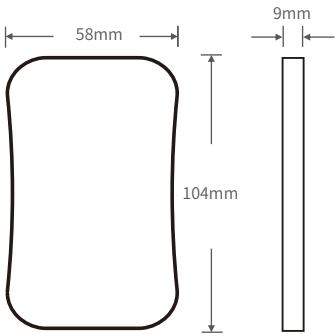

遥控器

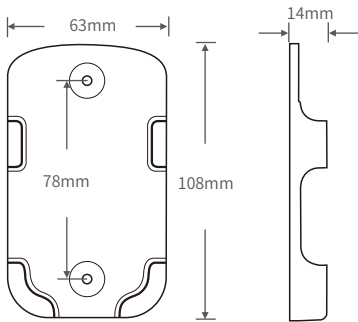

遥控器背托

MINI系列LED遥控器采用RF 2.4GHz无线传输技术，控制距离(无障碍时)最远可达30米。

搭配P5控制器，一台控制器兼容5路输出，支持DIM/CT/RGB/RGBW/RGBCW五种灯具类型，一个遥控器在有效的控制范围内可控制无数个控制器，实现灯光开/关、亮度调节、调节色温和RGB静态色、动态模式效果等功能；内置9种动态模式，可通过遥控进行编程修改，满足用户对不同灯光应用的需求；支持开启/关闭断电记忆模式；可设置控制器1~9秒的开关渐变时间。

产品安装

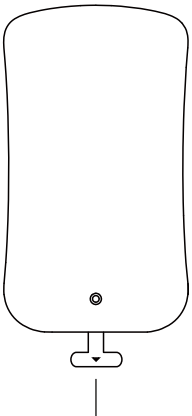
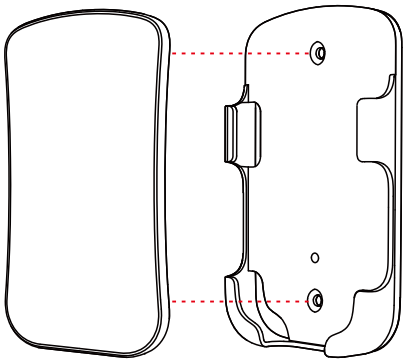

- 可以选择2种方式固定遥控器背托：
1. 用两个螺丝将遥控器背托固定在墙上。
 2. 用3M胶将遥控器背托固定在墙上。

注意：首次使用前，请抽出电池绝缘片

技术参数

产品型号	M9
产品颜色	白色
无线类型	RF 2.4GHz
工作电压	3Vdc (纽扣电池CR2032×1)
待机电流	<1uA
遥控距离	30米 (无障碍时)
工作温度	-30℃~55℃
产品重量	40克±10克
规格尺寸	104×58×9mm (遥控器), 108×63×14mm (遥控器+背托)

按键功能

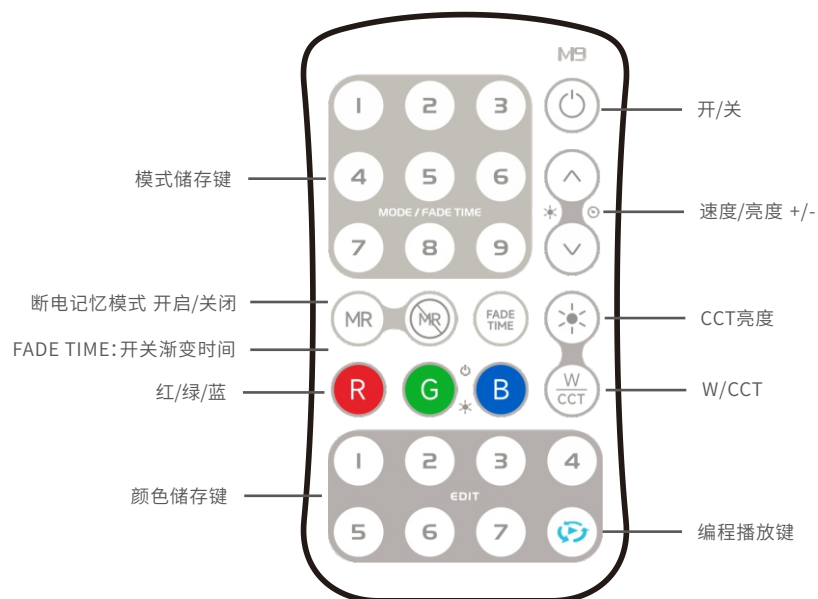

开/关: 短按开启或关闭灯光。

红/绿/蓝: 短按打开或关闭静态红色/绿色/蓝色通道；长按调节当前通道的亮度。

W/CCT: 短按打开或关闭W/CCT通道；长按调节W通道的亮度或调节CCT通道的色温。

CCT亮度: 长按调节CCT通道的亮度。

颜色储存键: 短按调用已保存的静态色；长按保存当前静态色。

编程播放键: 短按切换跳变、渐变、频闪，3种动态效果 (应用于已储存静态色之间的过渡)；
长按循环播放12种动态模式。

模式储存键: 短按调用动态模式；长按保存当前动态效果为动态模式。

速度/亮度 +/-: 短按调节动态模式的速度；长按调节动态模式的亮度。

断电记忆模式开关: 短按开启/ 关闭当前控制器的记忆模式。

开关渐变时间: 同时短按“FADE TIME”和模式储存键1~9，设置控制器的开关渐变时间 (1~9秒)。

重置按键功能

重置静态色:

关闭全部通道，长按当前需重置的颜色储存键保存，即可将当前静态色清除。

重置动态模式:

同时长按颜色储存键“5”和“编程播放键”，直到指示灯闪烁几次后熄灭，即表示所有动态模式重置成功。

同步遥控器的动态模式至控制器:

长按颜色储存键“1”和“4”，直到指示灯闪烁几次后熄灭，即表示已将遥控器编辑的动态模式全部同步到控制器中。

注：如果已重置了遥控器的动态模式，则需要将遥控器重置后的动态模式再次同步到控制器中，避免发生遥控器与控制器动态模式不同步，出现效果异常的情况。

配对控制器

有两种配对方式/删除方式可供用户选择。



方式一：按键对码

对码：

1. 短按控制器ID学习键，负载灯闪烁；
2. 在15秒内长按遥控器的开/关键，直到负载灯闪烁后常亮，即表示对码成功。

清码：

长按控制器ID学习键10秒，负载灯闪烁5次表示所有配对的控制器已全部删除。

方式二：上电对码

对码：

1. 将控制器断电；
2. 重新将控制器上电后，在3秒内长按遥控器上的开/关键，直到负载灯闪烁后常亮，即表示对码成功。

清码：

将控制器进行连续10次通断电的操作，负载灯闪烁5次表示所有配对的控制器已全部删除。

指示灯状态

- 灯开启时，如有按键操作，遥控指示灯显示红色。
- 30秒后无任何按键操作，遥控器将进入睡眠状态，需按任意键退出睡眠状态。

注意:如果按下按键LED灯不亮,有可能是电池没电,请及时更换电池。

运输和贮存

1. 运输

产品适用车、船、飞机交通运输工具运输。

在运输中，应使用遮蓬进行防雨和防晒，并保持文明装卸，不应有剧烈振动、撞击等。

2. 贮存

贮存符合I类环境的规定。贮存期限超过6个月的产品建议重新检验，合格后方可使用。

注意事项

- 限室内与干燥环境使用；
- 安装电池时，注意电池的正负极，长时间不使用遥控器，请取出电池；
- 当遥控距离变小或遥控频繁失效时，请及时更换电池；
- 应轻拿轻放，避免跌落造成损坏；
- 如果发生故障，请勿私自维修；如有疑问，请联系供应商。

* 本说明书的内容如有变更，恕不另行通知。若内容与您使用的功能有所不同，则以实物为准。如有疑问，请与供应商联系。

保修条例

- 自出厂之日起保修服务期为5年。
- 在保修服务期内出现产品质量问题雷特将给予免费修理或更换服务。

非保修条例：

属下列情况不在免费保修或更换服务范围之内：

- 已经超出保修服务期；
- 过高电压、超负载、操作不当等人为造成的损坏；
- 产品外形严重损坏或变形；
- 自然灾害以及人力不可抗拒原因造成的损坏；
- 产品保修标签和产品唯一条形码损坏；
- 无雷特签订的合同或发票凭证。

1. 修理或更换是雷特对客户的一补救措施。雷特不承担任何附带引起的损害赔偿，除非在适用法律范围之内。
2. 雷特享有修正或调整本保修条款的权利，并以书面形式发布为准。